

# The Town of Barnstable

## Department of Public Works

382 Falmouth Road, Hyannis, MA 02601

508.790.6400



Daniel W. Santos, P.E.

Director

Robert R. Steen, P.E.

Assistant Director

### Document A: Sewer Service Connection Form

(See enclosed Document B for instructions on filling out this form)

Is the property a Single Family, Duplex, Condominium or Business: \_\_\_\_\_

Full Cellar \_\_\_\_\_ Finished Cellar \_\_\_\_\_ Crawl Space \_\_\_\_\_ No Cellar \_\_\_\_\_

How does your sewer pipe exit your basement? Through the wall \_\_\_\_\_ Through the Floor \_\_\_\_\_

Comments:

**A. Property Sketch Instructions:** Please provide a sketch of your property in the "Property Sketch" area below and indicate the position of your building in relation to the surrounding street(s), including street name, building additions, garages, driveways, walkways, landscape features, location of existing septic system and where the existing sewer pipe leaves the house (if known), existing underground utilities, and the desired location of your new sewer service connection.

**B. Basement Section View Instructions:** Please circle the "Basement Section View" option that best represents where the sewer pipe exits your basement and provide the height measurement in the box provided.

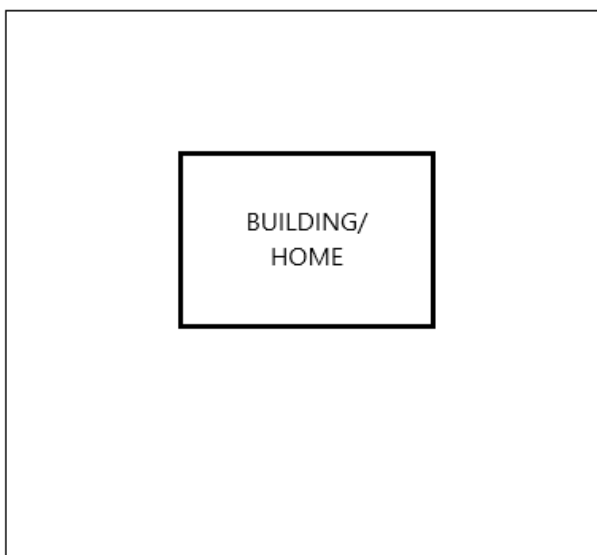

**A. Property Sketch**

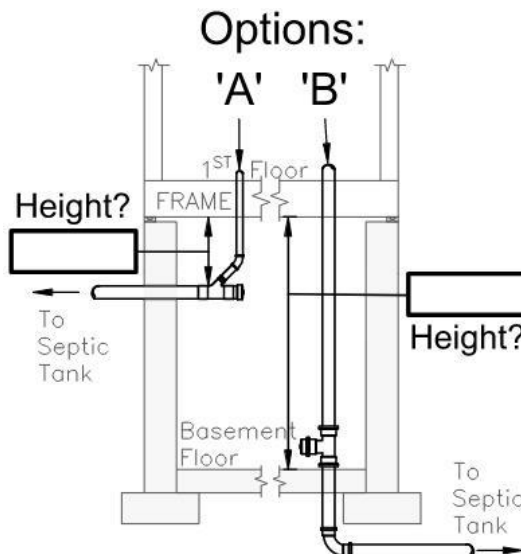

**B. Basement Section View**

OWNER'S NAME: \_\_\_\_\_ (PRINT) PHONE #: \_\_\_\_\_

PROPERTY ADDRESS: \_\_\_\_\_ EMAIL: \_\_\_\_\_

OWNER'S SIGNATURE: \_\_\_\_\_ DATE: \_\_\_\_\_

Please return a digital scan or photo of this form, or send a hard copy via the return envelope to the Barnstable Department of Public Works at 382 Falmouth Road, Hyannis, MA 02601. If you have any questions or wish to receive project updates, please contact Kelly Collopy, Communications Manager, at the DPW at 508-790-6400 or [Kelly.Collopy@town.barnstable.ma.us](mailto:Kelly.Collopy@town.barnstable.ma.us)